

BABY CAR SEAT

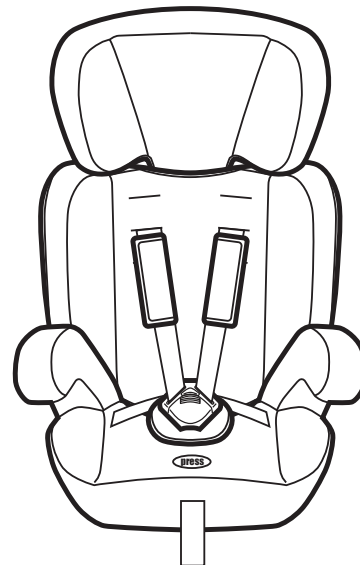

Group 1+2+3

9-36
kgs

Safety



Please read this user guide carefully before installing the child seat and for future reference.

1. This child seat is suitable for children from 9 to 18 kg (Group 1) and from 15 kg to 36 kg (Group 2.3)
2. Please read this instruction carefully otherwise incorrect installation will cause serious injury. In this case, the manufacturer will not take any responsibility.
3. This child seat is suitable for conventional use in all cars equipped with 3-point seat belts that are fitted in accordance with European standard (ECE-16 or equivalent standard), only fastening by leg belt is not allowed.
4. In any circumstance, the child seat can not be used in the front passenger seat with an active airbag.
5. Please don't use the child seat without the cover and chest pad.
6. Avoid direct sunlight from the child seat in case the high temperature hurts the child.
7. Seat and harness assemblies which get damaged or become badly worn must be replaced.
8. Do not place heavy objects on the parcel shelf. Which could, in the event of an accident, cause injury to the child.
9. Make sure the harness buckle is completely locked. In the event of an emergency, the child can be released quickly.
10. Make sure any part of the vehicle is not twisted by the folding door, and make sure the child seat is locked correctly.
11. Do not attempt to modify or add to any part of the child seat. Otherwise it will seriously affect its safety and function.
12. If there were no child placed in the child seat. The child seat still should be fastened by the vehicle safety belt. A child must never be left unattended with restrained, in or out of the vehicle.
13. If you have any question about the using and installation of the child seat. Please contact our service hotline: +34 943 833 600
14. Keep the child seat away from the corrosive.
15. The manufacturer guarantees the quality of the products. But not for the second-hand product.

Features

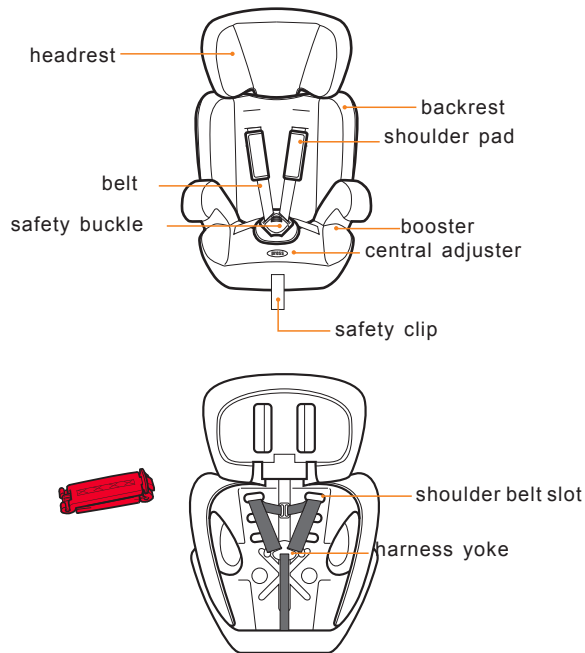

Vehicle Application



Correct fitting/suitable



Incorrect fitting/ not suitable

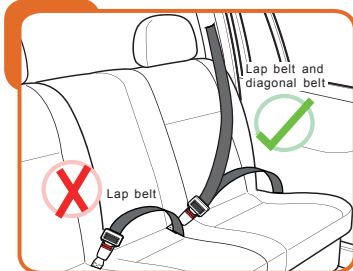

This child seat is suitable for conventional use in all cars equipped with 3 point seat belts that are fitted in accordance with European standard (ECE-16 or equivalent standard)

Important:

The child seat must only be installed using a lap and diagonal seat belt.



Warning:

Under no circumstances, should any child car seat be used on front passenger seat with an active airbag.

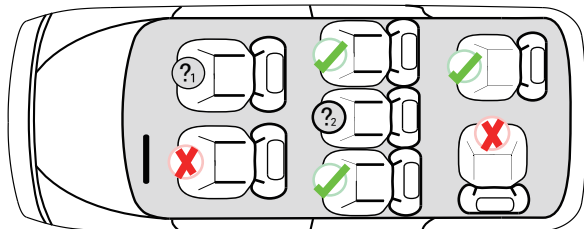

Not to be used on this seat if a Passenger front airbag is active.



Only use on this Seat if a lap and diagonal Seat belt is fitted.

Installing your child seat

Only for use with group 1 from approx.9 months to 4 year (9 -18 kgs)



Warning:

Do not use the child seat on a passenger seat fitted with an active airbag.

Place the child seat firmly against the back of the vehicle seat.

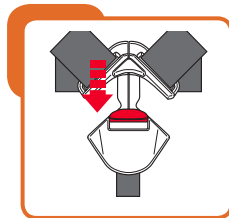
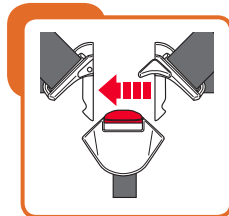

Insert the two piece of tongue inside the safety buckle when heard "click"



too low



too high



correct

Ensure the safety belt height position is just under the child shoulder.



Tighten the safety belt:

Firstly, put the child into the baby seat, put the harness into the middle of the child's legs, pass the both safety belts through the child chest to install the harness. Then pull the thin belt under the booster to tighten the child into the baby seat tightly. Ensure the safety belt are not twisted and not too loose again.



Loosen the safety belt:

Pull the both safety belts with one hand, meantime to push the "PRESS" on the booster, it is easily to loosen the safety belt.

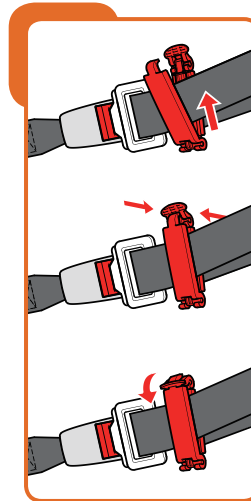

Insert the lap and the diagonal belt into the belt buckle ,you will hear a click when is correctly inserted. pull on it to check it is securely fitted. Then adjust the tightness of the belts.

Pull the lap and diagonal seat belt tightly and attach the belt clip to shoulders straps as closely as you can to the seat belt buckle, but not touching it .

Finally check that the seat is firm and secure ,if it is wobbly or slack ,you must tighten both again until the seat is secure.

Installing your child seat

For use with group 2,3 from approx. 3 to 12 year (15-36 kgs)

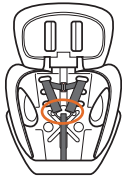

You will have to remove the harness and crotch strap first. To remove the harness, remove the shoulder belt from the belt connecting part as shown and then pull the shoulder belt through the shoulder pad and buckle. remove the shoulder belt from the bottom of booster.

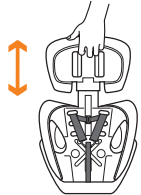

Adjust the headrest up and down to suitable the child height



Putting the child seat on the car seat. Pulling your child on the seat, fixing your child by the adult safety belt, and locking buckle until a "Click"

Installation of the booster

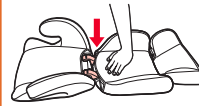

Pushing back the backrest, then taking out the backrest from the booster



Put the booster on the vehicle seat, fix it by the adult belt after the child sits on the baby seat, through the shoulder guide with the adult belt and fasten it well

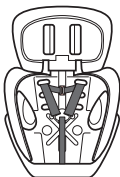

To remove the cover for cleaning , you must release the shoulder straps from the yoke and until the cords at the back of the child seat , pull these through to the front of the seat .

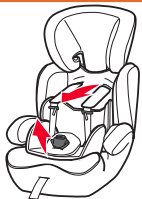
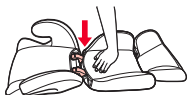

Take off the harness system and the seat cover according the picture shows.



Important:

The cover is a safety feature, never use the child seat without it. Don't put your child's safety at risk by using other makes of replacement cover, could stop the child seat from protecting your child as well as it should.

Washing instruction:

The cover is removable and washable at 30°C, line dry only.



Machine wash ,cold



Do not bleach



Dryclean, any solvent except Trichloroethylene



Do not tumble dry



Do not iron

European safety child seat is sweeping the whole world now



European safety standard

According to the product's quality, the requirements of the safety child seats is much higher in the European county. The latest ECE R44/04 standards went into effect at June of 2006, the standard high tested by more realistic collision testing, makes much stricter stipulates for the head protection and safety belt system etc, make it as the most strictest standard in the world.